

ERECTED. 1882
 TYPE. BRICK
 FOUNDATION. STONE
 WALLS. BRICK
 ROOF TYPE. GABLE. SHINGLE.
 PITCH. 1/2
 HEATING. STEAM.
 FLOOR. 7/8 x 3 1/2 MAPLE.
 FINISH { INSIDE PLASTER PAINTED.
 OUTSIDE BRICK PAINTED.
 CEILING HEIGHT. 12'-11". 2ND STORY. 11'-0".
 LIGHTING. ELECTRIC.
 SANITARY FACILITIES. SEE PLAN.

SECOND FLOOR PLAN.
 SCALE - 1" = 20'-0"

MAIN STREET
 SIDE WALK.

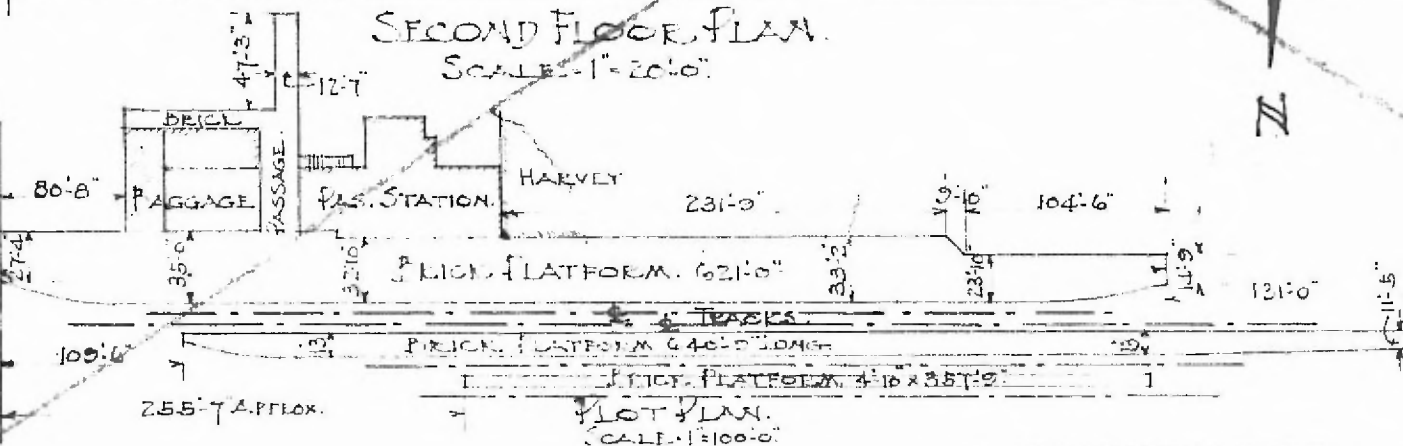

VOID.
 SEE NEW
 DRAWING.

PASSENGER STATION
 SPRINGFIELD, MO.

50

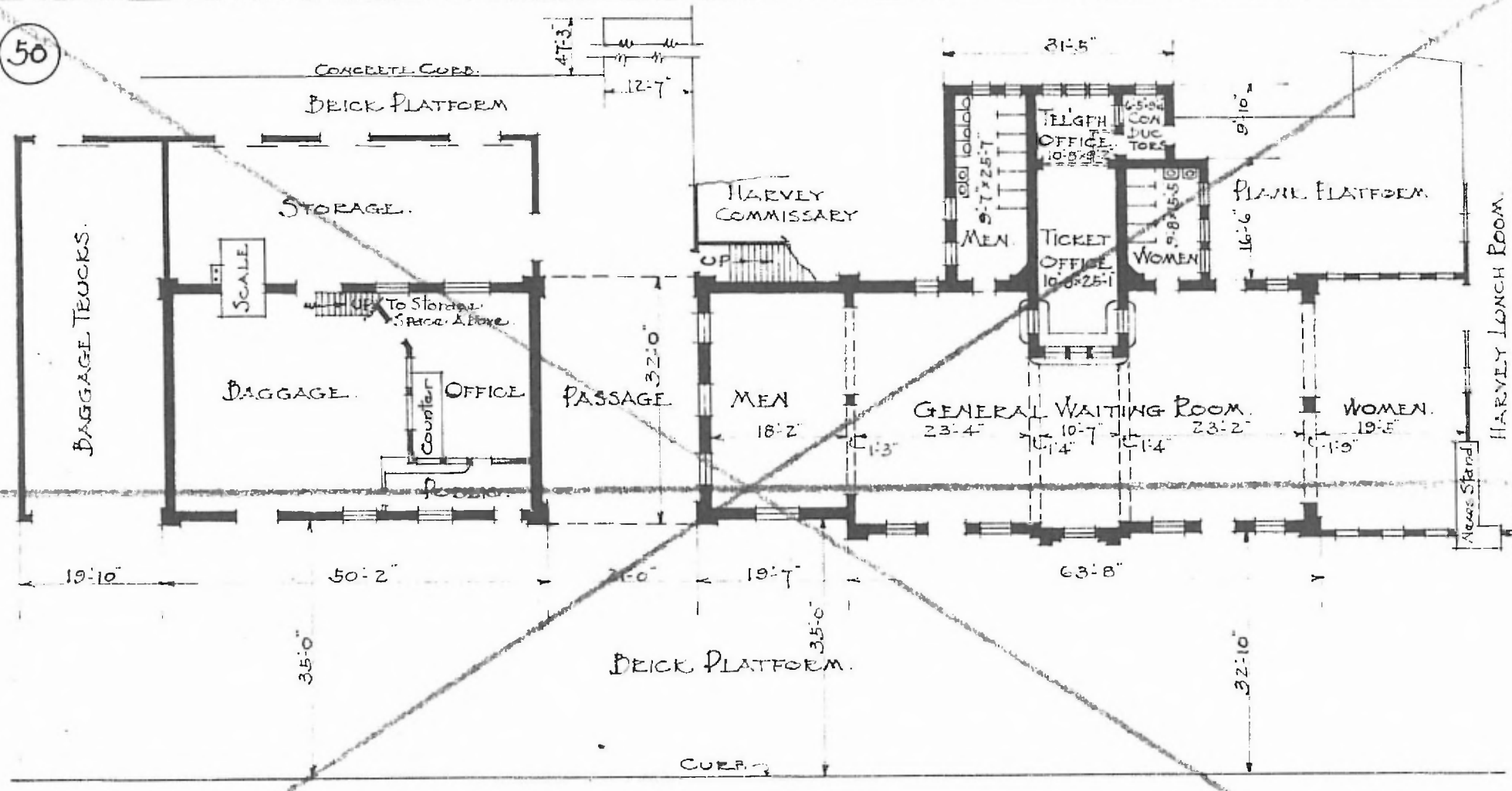

FIRST FLOOR PLAN
SCALE: 1" = 20'-0"

VOID SEE.
NEW DRAWING.

PASSENGER STATION
SPRINGFIELD, MO.

DEC. 12. 1916.